

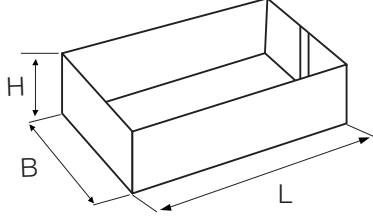

- Paslanmaz çelik gövde ve aksamlar
- PLC kontrol sistemi (SIEMENS)
- 7" renkli LCD Türkçe operatör paneli (SIEMENS)
- Zaman ve hız ayarları operatör paneli üzerinden
- Otomatik tava katlama ve yapıştırma sistemi
- Mekanik güvenlik anahtarlı güvenlik kapıları (SICK)
- Kapılar açıldığında otomatik durma
- Koli magazin haznesi (100 koli kapasiteli)
- Manüel koli ölçü ayarı
- Kolay ulaşılabilir Acil Stop butonları
- Kolay ve hızlı ölçü ayar değişimi
- Yağlama gerektirmeyen pnömomatik sistem (FESTO)
- Uluslararası standartlara uygun tüm tava çeşitleri ile çalışma
- Minimum bakım gereksinimi
- CE sertifikalı

- Stainless Steel body and parts
- PLC control system (SIEMENS)
- 7" coloured LCD operator panel (SIEMENS)
- Timing and speed adjustment on operator panel
- Automatic tray folder and hot-melt glue system
- Safety doors with mechanical safety switches (SICK)
- Automatic stop when doors are opened
- Box storage for 100 boxes
- Manuel dimension adjustment
- Emergency Stop buttons
- Easy and fast size setting
- Pneumatic system that does not require lubrication (FESTO)
- Working with all tray types in accordance with international standards
- Minimum maintenance requirement
- CE certificated

**Tava Ölçüleri**  
Tray Dimensions



TTH-10			
	L (mm)	B (mm)	H (mm)
Min.	150	150	30
Max.	450	450	100

TTH-20			
	L (mm)	B (mm)	H (mm)
Min.	200	200	30
Max.	650	650	100

\*\*\*Farklı Ebatlar İçin Bizimle İrtibata Geçiniz  
\*\*\*For Different Case Size Please Contact Us

**Kapasite**  
Capacity

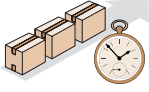

TTH-10 / TTH-20	
Max. 10-30 Tava/Dakika - Tray/Minute**	

\*\* Tava şekli ve ölçüsüne göre değişmektedir.  
\*\* It depends on tray shape and dimensions

**Elektrik Bağlantı**  
Electrical Connection

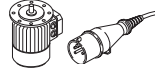

380V - 50Hz- 3 Ph
5A
1,4 Kw
3Ph + PE + N

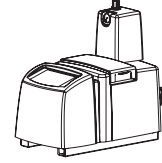

380V - 50Hz- 3 Ph
32 A
1,8 Kw
3Ph + PE + N

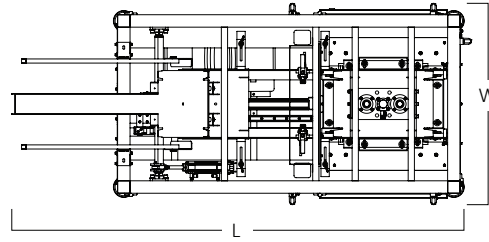
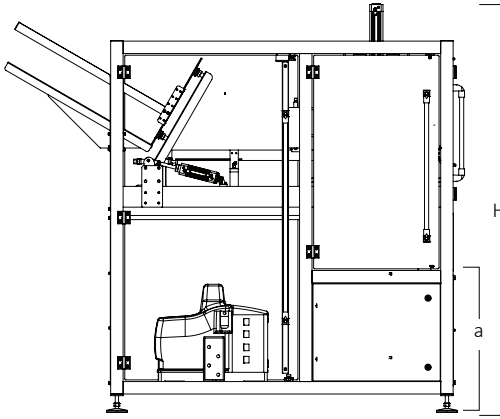

**Hava Bağlantı**  
Air Connection

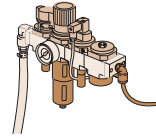



5-7 Bar
0.3 Lt
Ø10 mm

**Makine Ölçüleri**  
Machine Dimensions

(mm)	TTH-10				TTH-20			
	L	W	H	a	L	W	H	a
Min.	2.150	1.000	1.750	500	2.350	1.200	1.750	500
Max.	-	-	1.850	800	-	-	1.850	800

\*\* Tava şekli ve ölçüsüne göre değişmektedir.  
\*\* It depends on tray shape and dimensions

**Ağırlık - Paket Ölçüleri**  
Weight - Packaging Size

			LxWxH (cm)
TTH-10	500	600	220X105X190
TTH-20	600	700	240X125X190

FEFCO 0300

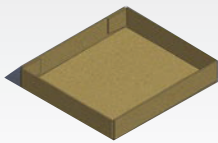

FEFCO 0300 DEEP

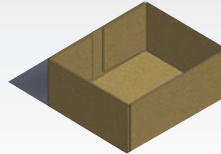

FEFCO 0301

